

NOTES

- 1- ALL DIMENSIONS AND ANGLES SHOULD BE GIVEN IN CONCRETE WORKING DRAWINGS BEFORE CONSTRUCTION.
- 2- ALL DIMENSIONS AND LETTERS ARE IN MILLIMETERS UNLESS OTHERWISE NOTED OTHERWISE.
- 3- THE CURING PERIOD FOR CONCRETE SHOULD NOT BE LESS THAN 28 DAYS.
- 4- THE CEMENT USED FOR BOTH PLAN AND REINFORCED CONCRETE UNDERGROUND LEVEL IS QUIAPALTE RESISTIVE PORTLAND CEMENT.
- 5- STEEL USED IN REINFORCED WORK IS HIGH TENSILE STEEL, 360 MPa FOR DIAMETERS 10mm AND MILD STEEL, 240 MPa FOR 8mm.
- 6- THE REINFORCEMENT OF COLUMNS SHALL BE TAKEN FROM COLUMN DETAILS.
- 7- CONCRETE COVER SHOULD NOT BE LESS THAN 25 mm FOR COLUMNS.
- 8- DESIGN IS REFERRED TO THE REQUIREMENTS OF THE EQUATION CODE FOR PRACTICE CODE.
- 9- CONCRETE USED SHALL BE VERY DENSE AND CURING SHALL BE ACCORDING TO EQUATION CODE OR PRACTICE CODE.
- 10- 10.1.3 THE GIBBY OF -
- 11- 10.1.3 THE GIBBY OF -
- 12- 10.1.3 THE GIBBY OF -
- 13- 10.1.3 THE GIBBY OF -
- 14- 10.1.3 THE GIBBY OF -
- 15- 10.1.3 THE GIBBY OF -
- 16- 10.1.3 THE GIBBY OF -
- 17- 10.1.3 THE GIBBY OF -
- 18- 10.1.3 THE GIBBY OF -
- 19- 10.1.3 THE GIBBY OF -
- 20- 10.1.3 THE GIBBY OF -
- 21- 10.1.3 THE GIBBY OF -
- 22- 10.1.3 THE GIBBY OF -
- 23- 10.1.3 THE GIBBY OF -
- 24- 10.1.3 THE GIBBY OF -
- 25- 10.1.3 THE GIBBY OF -
- 26- 10.1.3 THE GIBBY OF -
- 27- 10.1.3 THE GIBBY OF -
- 28- 10.1.3 THE GIBBY OF -
- 29- 10.1.3 THE GIBBY OF -
- 30- 10.1.3 THE GIBBY OF -
- 31- 10.1.3 THE GIBBY OF -
- 32- 10.1.3 THE GIBBY OF -
- 33- 10.1.3 THE GIBBY OF -
- 34- 10.1.3 THE GIBBY OF -
- 35- 10.1.3 THE GIBBY OF -
- 36- 10.1.3 THE GIBBY OF -
- 37- 10.1.3 THE GIBBY OF -
- 38- 10.1.3 THE GIBBY OF -
- 39- 10.1.3 THE GIBBY OF -
- 40- 10.1.3 THE GIBBY OF -
- 41- 10.1.3 THE GIBBY OF -
- 42- 10.1.3 THE GIBBY OF -
- 43- 10.1.3 THE GIBBY OF -
- 44- 10.1.3 THE GIBBY OF -
- 45- 10.1.3 THE GIBBY OF -
- 46- 10.1.3 THE GIBBY OF -
- 47- 10.1.3 THE GIBBY OF -
- 48- 10.1.3 THE GIBBY OF -
- 49- 10.1.3 THE GIBBY OF -
- 50- 10.1.3 THE GIBBY OF -
- 51- 10.1.3 THE GIBBY OF -
- 52- 10.1.3 THE GIBBY OF -
- 53- 10.1.3 THE GIBBY OF -
- 54- 10.1.3 THE GIBBY OF -
- 55- 10.1.3 THE GIBBY OF -
- 56- 10.1.3 THE GIBBY OF -
- 57- 10.1.3 THE GIBBY OF -
- 58- 10.1.3 THE GIBBY OF -
- 59- 10.1.3 THE GIBBY OF -
- 60- 10.1.3 THE GIBBY OF -
- 61- 10.1.3 THE GIBBY OF -
- 62- 10.1.3 THE GIBBY OF -
- 63- 10.1.3 THE GIBBY OF -
- 64- 10.1.3 THE GIBBY OF -
- 65- 10.1.3 THE GIBBY OF -
- 66- 10.1.3 THE GIBBY OF -
- 67- 10.1.3 THE GIBBY OF -
- 68- 10.1.3 THE GIBBY OF -
- 69- 10.1.3 THE GIBBY OF -
- 70- 10.1.3 THE GIBBY OF -
- 71- 10.1.3 THE GIBBY OF -
- 72- 10.1.3 THE GIBBY OF -
- 73- 10.1.3 THE GIBBY OF -
- 74- 10.1.3 THE GIBBY OF -
- 75- 10.1.3 THE GIBBY OF -
- 76- 10.1.3 THE GIBBY OF -
- 77- 10.1.3 THE GIBBY OF -
- 78- 10.1.3 THE GIBBY OF -
- 79- 10.1.3 THE GIBBY OF -
- 80- 10.1.3 THE GIBBY OF -
- 81- 10.1.3 THE GIBBY OF -
- 82- 10.1.3 THE GIBBY OF -
- 83- 10.1.3 THE GIBBY OF -
- 84- 10.1.3 THE GIBBY OF -
- 85- 10.1.3 THE GIBBY OF -
- 86- 10.1.3 THE GIBBY OF -
- 87- 10.1.3 THE GIBBY OF -
- 88- 10.1.3 THE GIBBY OF -
- 89- 10.1.3 THE GIBBY OF -
- 90- 10.1.3 THE GIBBY OF -
- 91- 10.1.3 THE GIBBY OF -
- 92- 10.1.3 THE GIBBY OF -
- 93- 10.1.3 THE GIBBY OF -
- 94- 10.1.3 THE GIBBY OF -
- 95- 10.1.3 THE GIBBY OF -
- 96- 10.1.3 THE GIBBY OF -
- 97- 10.1.3 THE GIBBY OF -
- 98- 10.1.3 THE GIBBY OF -
- 99- 10.1.3 THE GIBBY OF -
- 100- 10.1.3 THE GIBBY OF -

SUPERVISORS

PROJECT NAME

Latrine

8/

Eng/ Afrah Mustafa

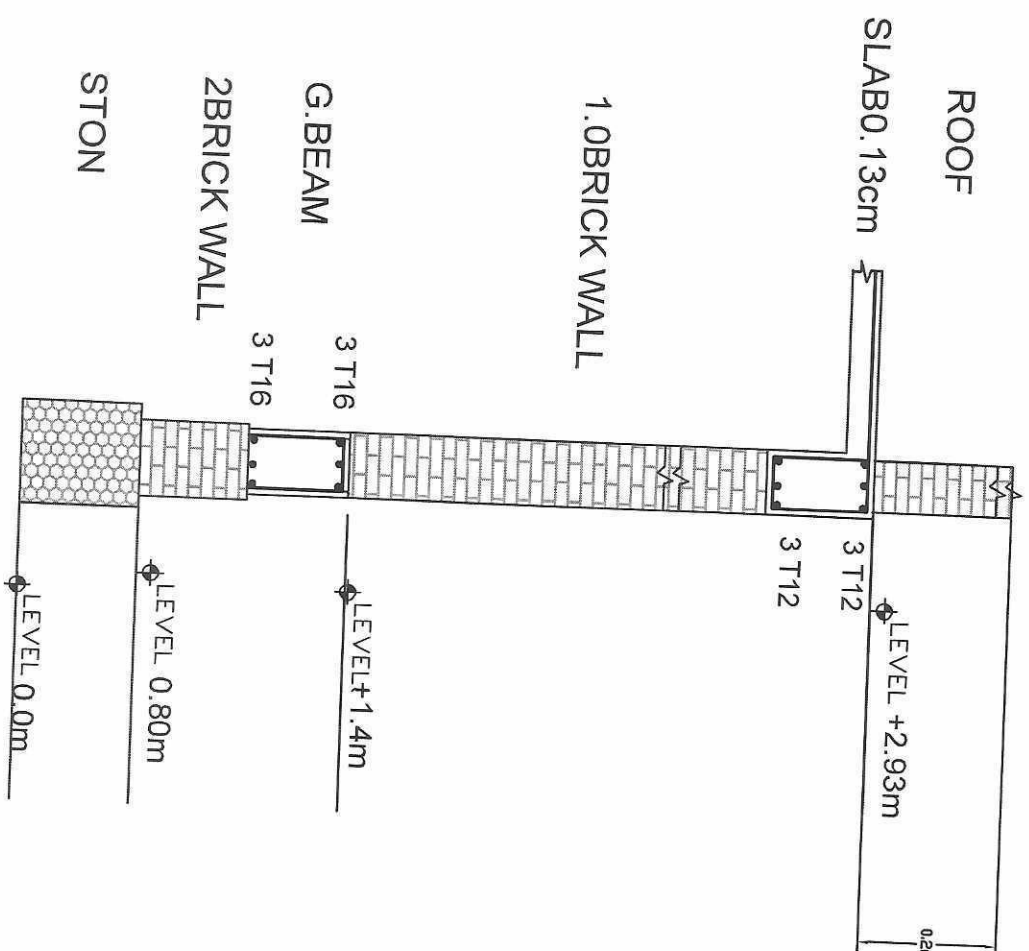

Section X.X

NOTES

- 1- ALL DIMENSIONS AND AREAS SHOULD BE READ IN CONJUNCTION WITH ARCHITECTURAL DRAWINGS BEFORE CONSTRUCTION.
- 2- ALL DIMENSION AND LEVELS ARE IN UNITS OF METRE NOTION ON PLAN.
- 3- THE CUBIC STRENGTH OF THE CONCRETE SHALL BE NOT LESS THAN 20 Kg/cm².
- 4- THE COVER OF SLAB FOR BOTH TOP AND BOTTOM SHOULD BE 20mm AND REINFORCED CONCRETE UNDER COLUMN LEVELS SHALL HAVE REBAR END PORTLAND CEMENT.
- 5- STEEL USED IN REB. SHALL BE SAE 4140 HIGH TENSILE STEEL REBAR FOR DIAMETERS UP TO 16mm AND MILD STEEL 235S FOR 8mm.
- 6- THE REINFORCEMENT OF COLUMN SHALL BE TAKEN FROM COLUMN DETAILS.
- 7- CONCRETE COVER SHOULD NOT BE LESS THAN 25 mm FOR COLUMN.
- 8- DIMENSIONS REFERRED TO THE REQUIREMENTS OF THE EGYPTIAN CODE OF PRACTICE (2007).
- 9- CONCRETE USED SHOULD BE VERY DENSE AND CURING MUST BE ACCORDING TO EGYPTIAN CODE OF PRACTICE (2007).

10- AS THE DIRECTOR
 11- THE DESIGNER
 12- THE CHECKER
 13- THE BRIST TENDON OF COLUMN SECTION
 14- IS THE BRIST OF 1 in 40
 15- CONSTRUCTION JOINTS IN FLOOR SHALL BE LOCATED WITHIN THE MIDDLE THIRD OF THE SLAB AND BEING.

SUPERVISOR:
 PROJECT NAME:
 Lathne
 DRAWING TITLE:
 section X.X
 By:
 Eng/ Afrah Mustafa

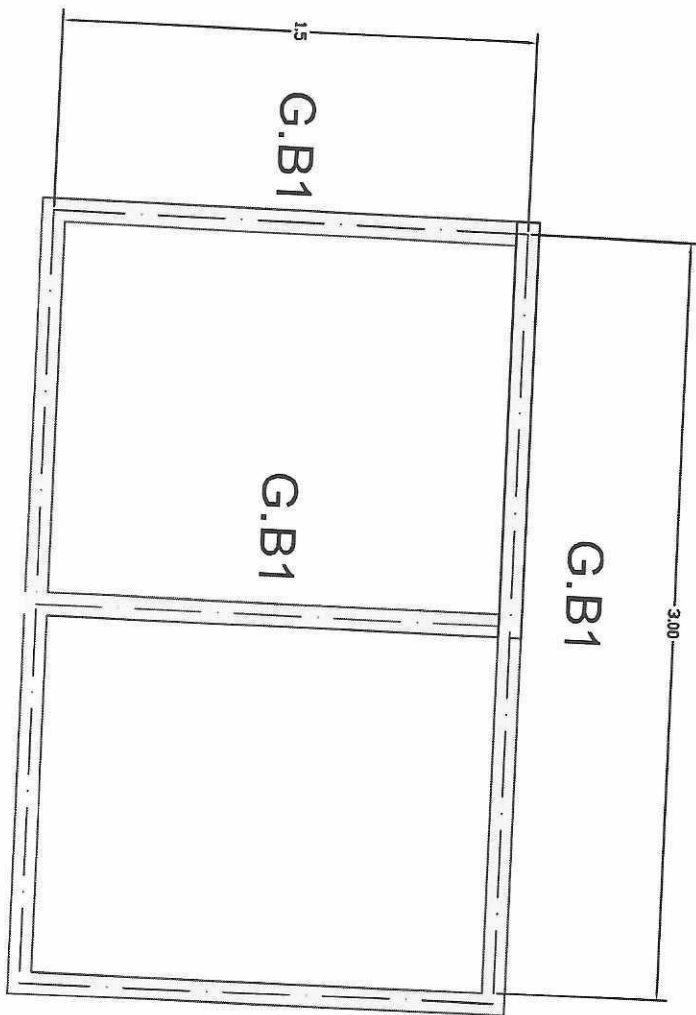

GREAD BEAM

G.B.1

NOTES

- 1- ALL DIMENSIONS AND NET GRADE BE READY FOR CONTRACT DOCUMENTS.
- 2- ALL DIMENSIONS AND LEVELS ARE IN UNITS OF METERS UNLESS OTHERWISE SPECIFIED.
- 3- ALL DIMENSIONS AND LEVELS ARE IN UNITS OF METERS UNLESS OTHERWISE SPECIFIED.
- 4- THE CONTRACTOR SHALL BE RESPONSIBLE FOR OBTAINING ALL NECESSARY PERMITS AND APPROVALS FROM THE RELEVANT AUTHORITIES.
- 5- THE CONTRACTOR SHALL BE RESPONSIBLE FOR OBTAINING ALL NECESSARY PERMITS AND APPROVALS FROM THE RELEVANT AUTHORITIES.
- 6- THE CONTRACTOR SHALL BE RESPONSIBLE FOR OBTAINING ALL NECESSARY PERMITS AND APPROVALS FROM THE RELEVANT AUTHORITIES.
- 7- THE CONTRACTOR SHALL BE RESPONSIBLE FOR OBTAINING ALL NECESSARY PERMITS AND APPROVALS FROM THE RELEVANT AUTHORITIES.
- 8- THE CONTRACTOR SHALL BE RESPONSIBLE FOR OBTAINING ALL NECESSARY PERMITS AND APPROVALS FROM THE RELEVANT AUTHORITIES.
- 9- THE CONTRACTOR SHALL BE RESPONSIBLE FOR OBTAINING ALL NECESSARY PERMITS AND APPROVALS FROM THE RELEVANT AUTHORITIES.
- 10- THE CONTRACTOR SHALL BE RESPONSIBLE FOR OBTAINING ALL NECESSARY PERMITS AND APPROVALS FROM THE RELEVANT AUTHORITIES.
- 11- THE CONTRACTOR SHALL BE RESPONSIBLE FOR OBTAINING ALL NECESSARY PERMITS AND APPROVALS FROM THE RELEVANT AUTHORITIES.
- 12- THE CONTRACTOR SHALL BE RESPONSIBLE FOR OBTAINING ALL NECESSARY PERMITS AND APPROVALS FROM THE RELEVANT AUTHORITIES.
- 13- THE CONTRACTOR SHALL BE RESPONSIBLE FOR OBTAINING ALL NECESSARY PERMITS AND APPROVALS FROM THE RELEVANT AUTHORITIES.
- 14- THE CONTRACTOR SHALL BE RESPONSIBLE FOR OBTAINING ALL NECESSARY PERMITS AND APPROVALS FROM THE RELEVANT AUTHORITIES.
- 15- THE CONTRACTOR SHALL BE RESPONSIBLE FOR OBTAINING ALL NECESSARY PERMITS AND APPROVALS FROM THE RELEVANT AUTHORITIES.

PROJECT NAME:
Lathne

Eng/ Afnan Mustafa